

**RENOVATION:**

TABLE + CHAIR  
STORAGE  
533 S.F.

CAFETERIA  
EXPANSION  
1,910 S.F.

**SCHEME ONE:**

RENOVATION:  
5,206 S.F. (TOTAL)

NEW CONSTRUCTION:  
47,400 S.F. (TOTAL)

NEW PARKING LOT-138  
PARKING SPACES MAX.

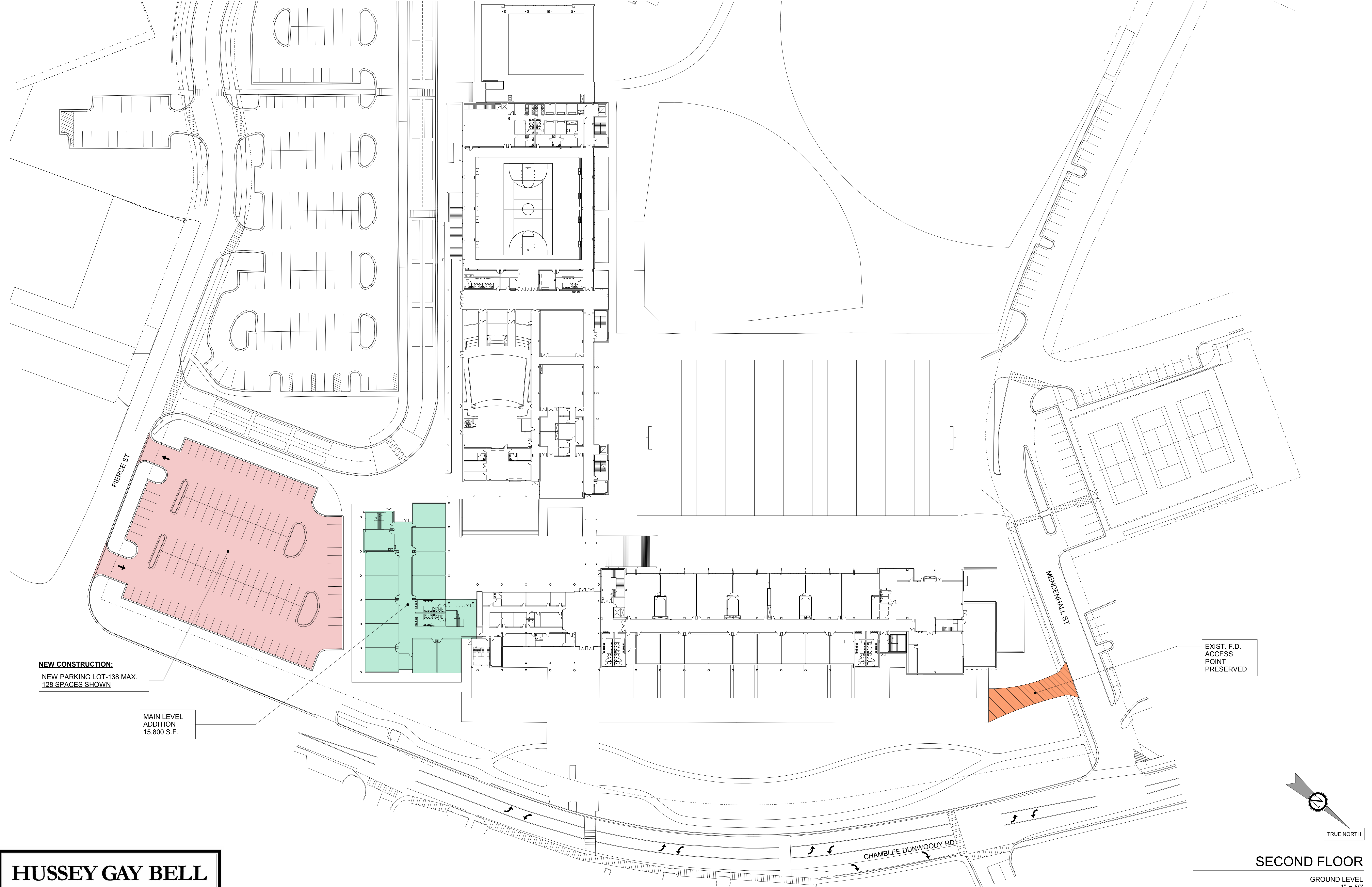

**NEW CONSTRUCTION:**  
 NEW PARKING LOT-138 MAX.  
 128 SPACES SHOWN

MAIN LEVEL  
 ADDITION  
 15,800 S.F.

EXIST. F.D.  
 ACCESS  
 POINT  
 PRESERVED

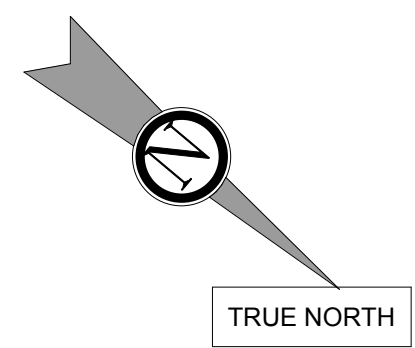

**HUSSEY GAY BELL**  
*Established 1958*

CHAMBLEE CHARTER HIGH SCHOOL

OCTOBER 9TH, 2018

SECOND FLOOR

GROUND LEVEL  
 1" = 50'

SCHEME I

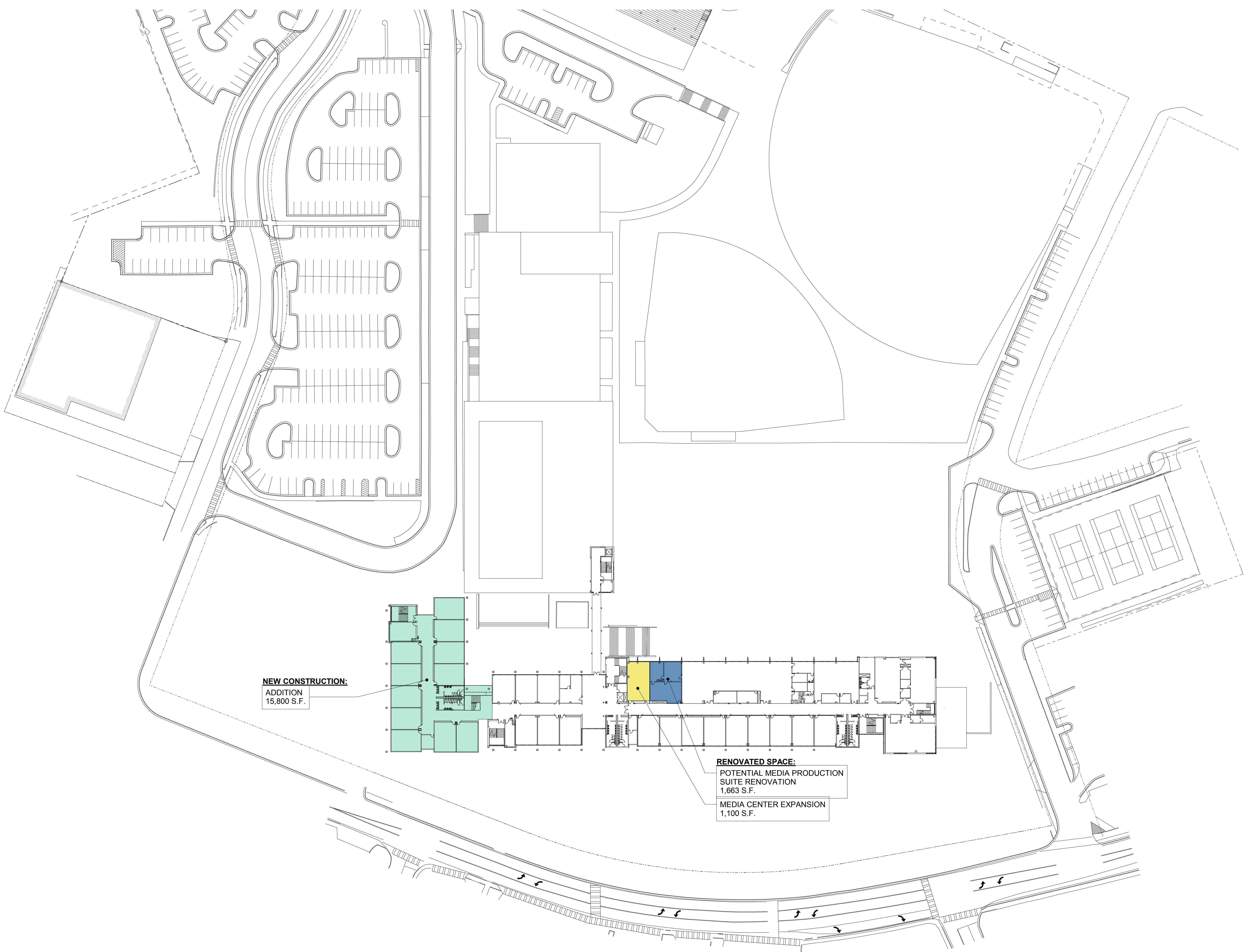

**NEW CONSTRUCTION:**  
ADDITION  
15,800 S.F.

**RENOVATED SPACE:**  
POTENTIAL MEDIA PRODUCTION  
SUITE RENOVATION  
1,663 S.F.  
MEDIA CENTER EXPANSION  
1,100 S.F.

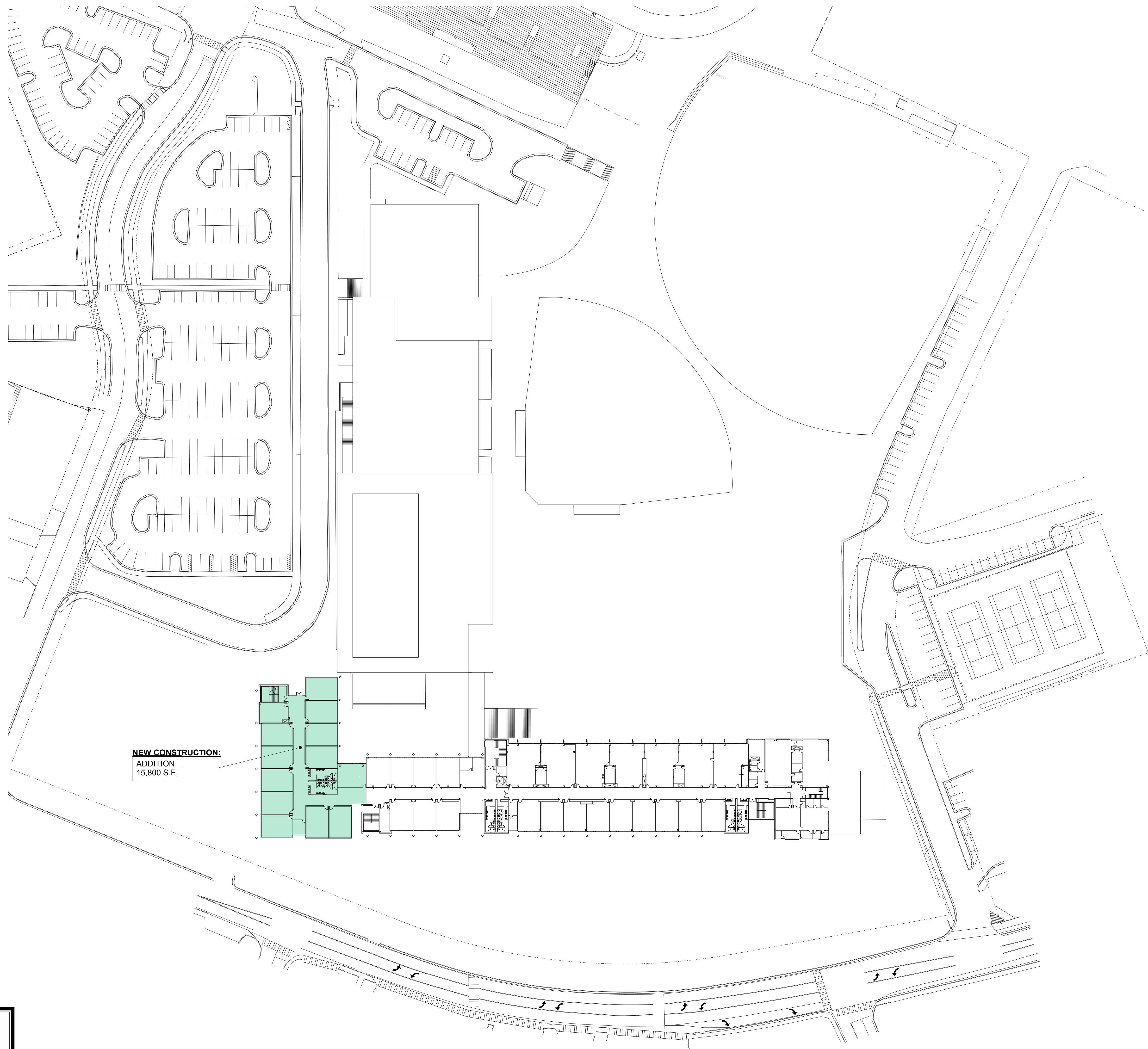

**NEW CONSTRUCTION:**  
ADDITION  
15,800 S.F.

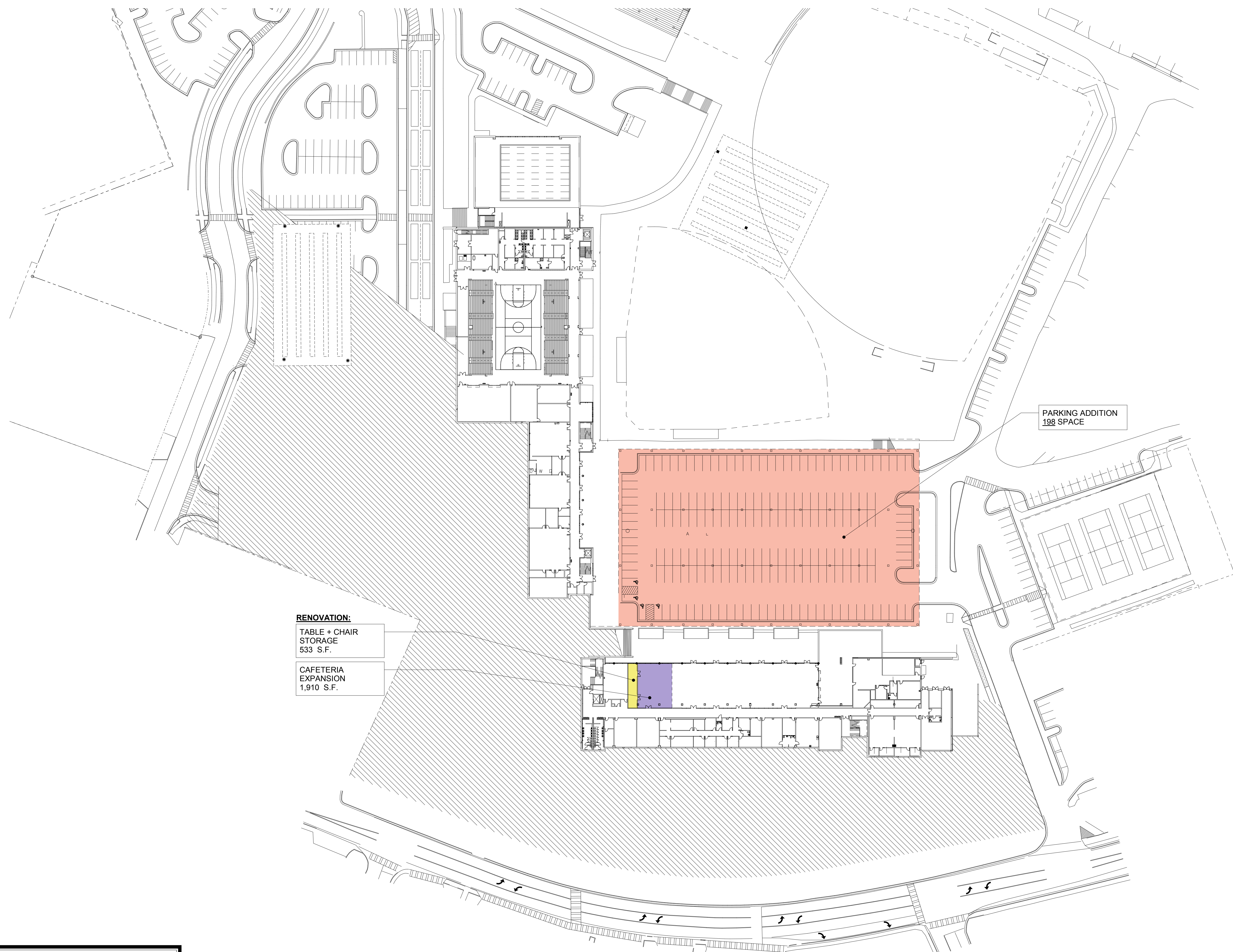

**RENOVATION:**

TABLE + CHAIR  
STORAGE  
533 S.F.

CAFETERIA  
EXPANSION  
1,910 S.F.

PARKING ADDITION  
198 SPACE

**SCHEME THREE:**

RENOVATION:  
5,206 S.F. (TOTAL)

NEW CONSTRUCTION:  
50,235 S.F. (TOTAL)

NEW PARKING LOT-198  
PARKING SPACES MAX.

**HUSSEY GAY BELL**

Established 1958

CHAMBLEE CHARTER HIGH SCHOOL

FIRST FLOOR

BASEMENT LEVEL  
1" = 50'

SCHEME III

DATE: 10-08-2018

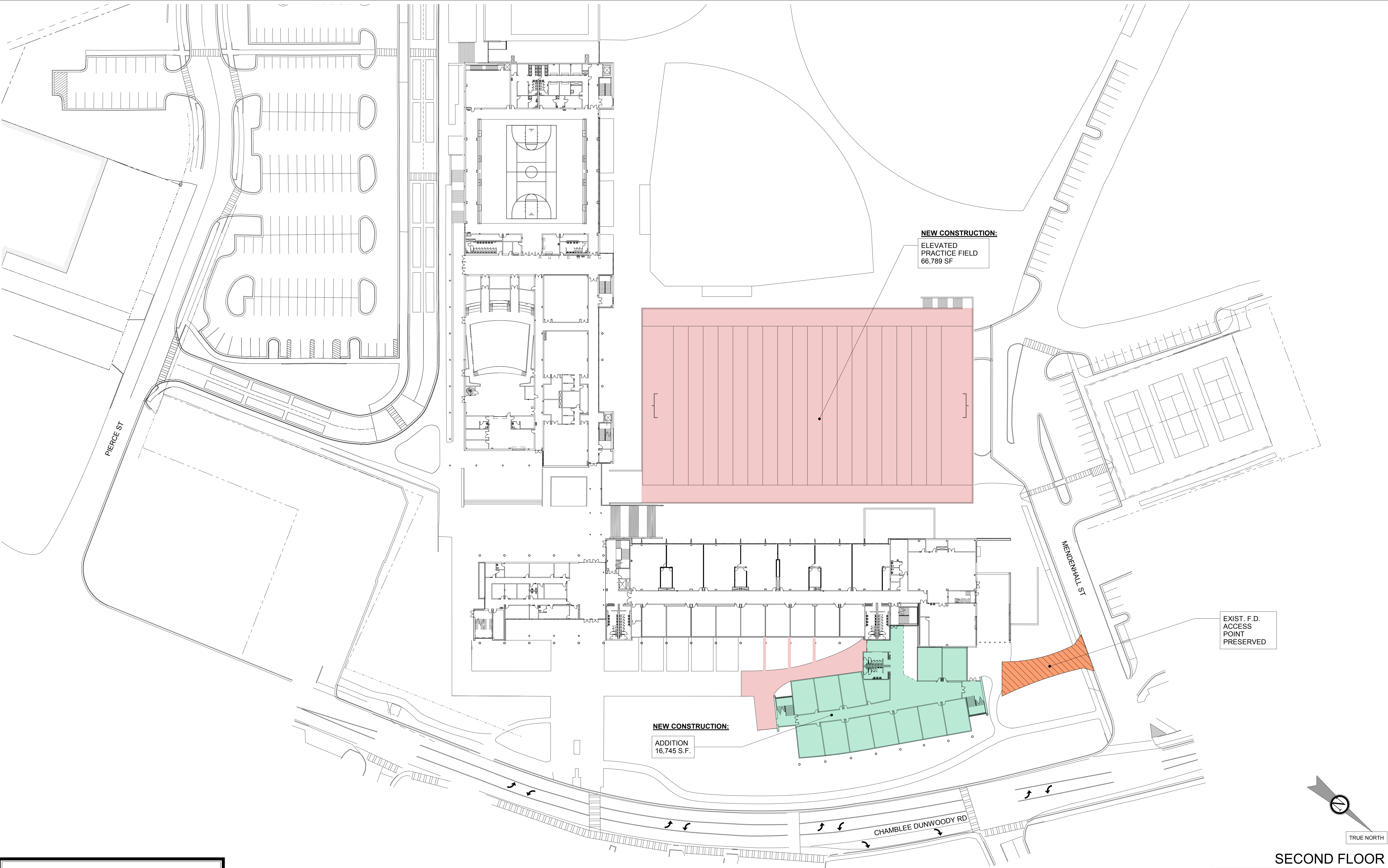

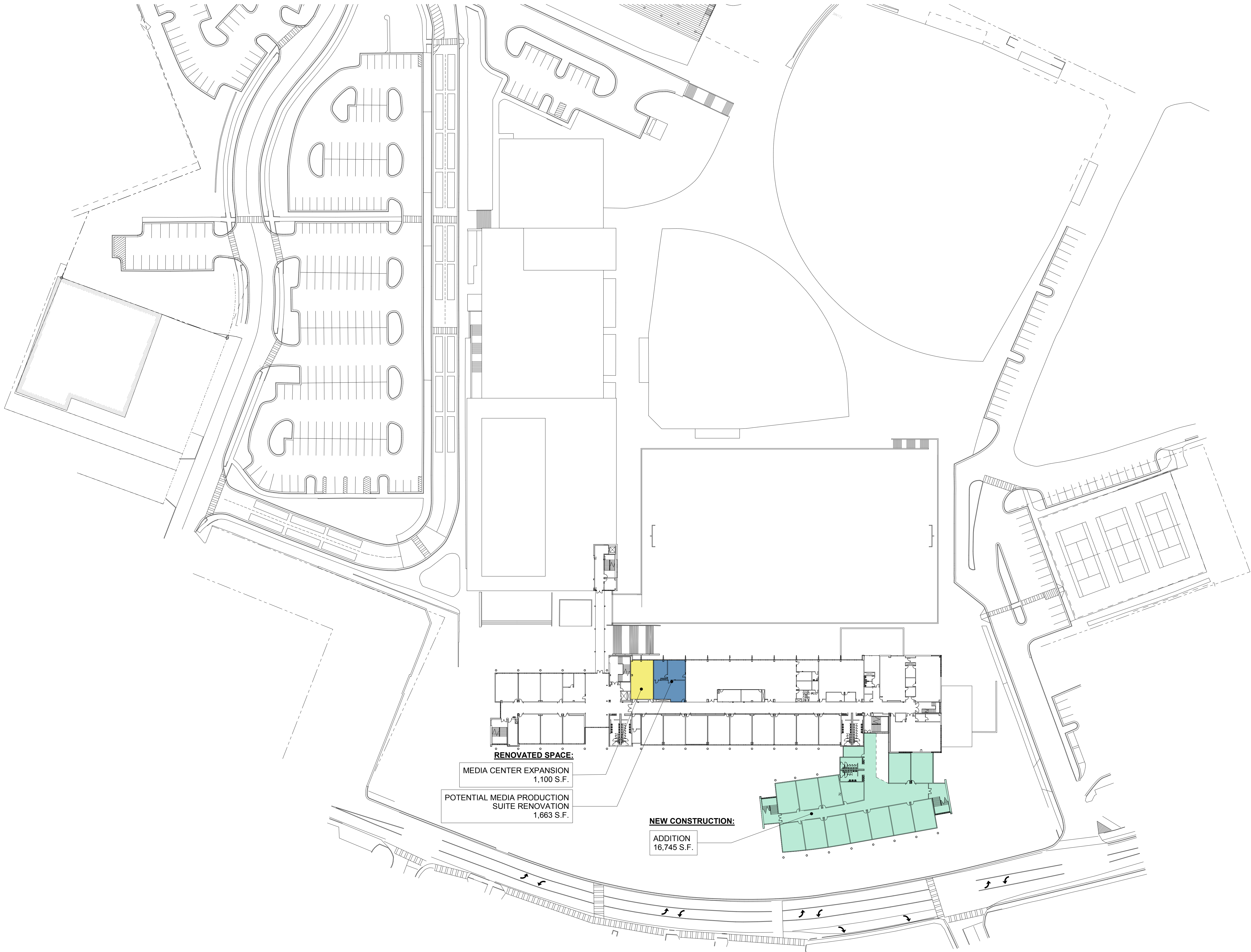

**RENOVATED SPACE:**  
 MEDIA CENTER EXPANSION  
 1,100 S.F.  
 POTENTIAL MEDIA PRODUCTION  
 SUITE RENOVATION  
 1,663 S.F.

**NEW CONSTRUCTION:**  
 ADDITION  
 16,745 S.F.

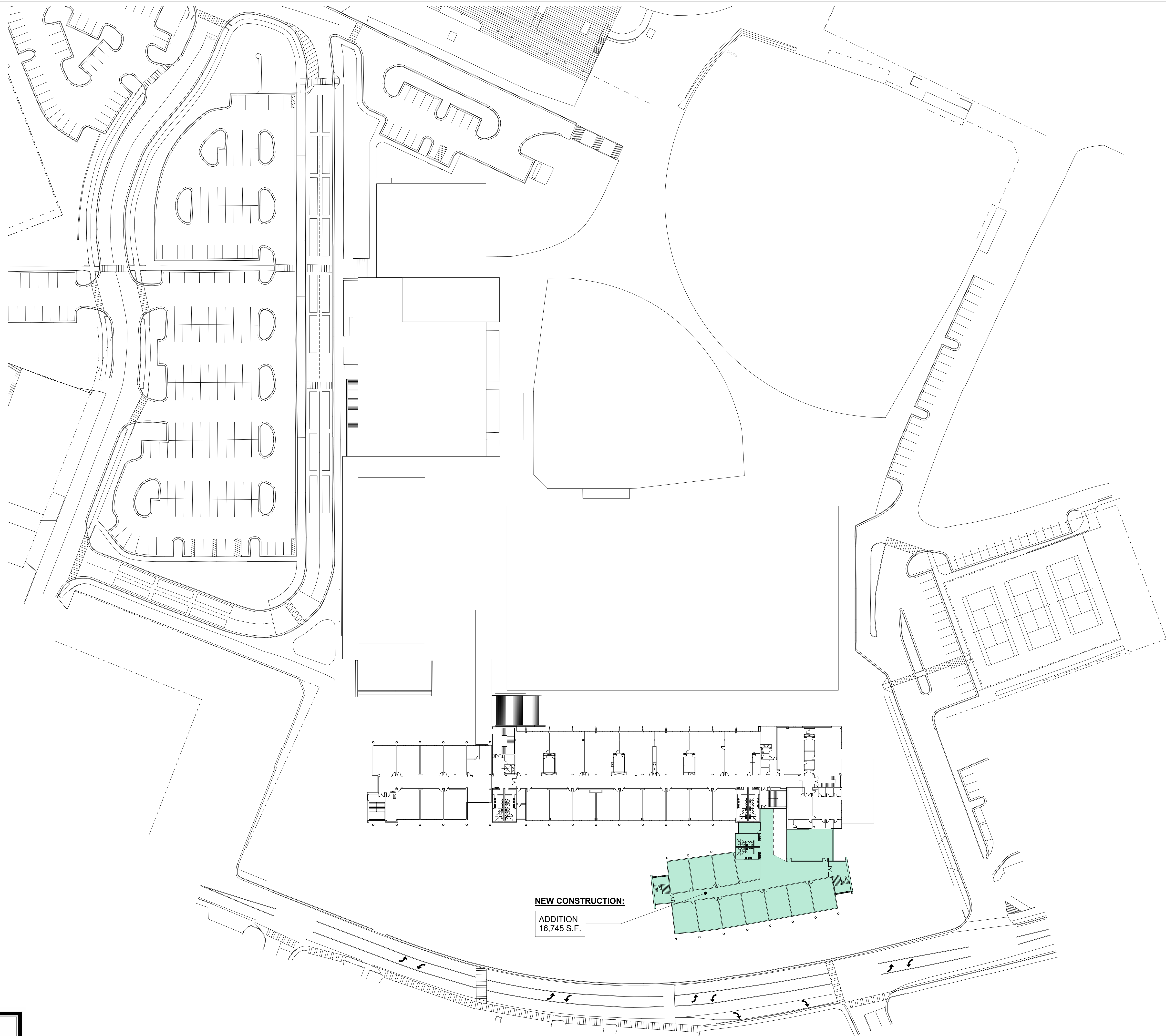

**NEW CONSTRUCTION:**

ADDITION  
16,745 S.F.

FOURTH FLOOR

1" = 50'

**HUSSEY GAY BELL**

Established 1958

CHAMBLEE CHARTER HIGH SCHOOL

DATE: 10-08-2018

SCHEME III